





# AREA 1

## LEGEND

### TREE IMPACT ASSESSMENT KEY

-  TREES FOR RETENTION
-  TREES REMOVED DUE TO DEVELOPMENT
-  CATEGORY C TREES TO BE REMOVED IN THE INTERESTS OF IMPROVING OPEN SPACE ACCESSIBILITY
-  TREES RECOMMENDED FOR REMOVAL DUE TO ARBORICULTURAL PRINCIPLES

DRAWING TO BE INTERPRETED WITH REFERENCE TO THE ARBORICULTURAL ASSESSMENT & IMPACT REPORT

PATH AT THIS LOCATION WILL REQUIRE A NO-DIG METHOD OF INSTALLATION AND USE OF ROOT CONFINEMENT SYSTEM. CROWNS WILL ALSO REQUIRE RAISING TO 2.4M. REFER TO ARBORICULTURAL REPORT FOR FURTHER.



ENTIRE SITE N.T.S.

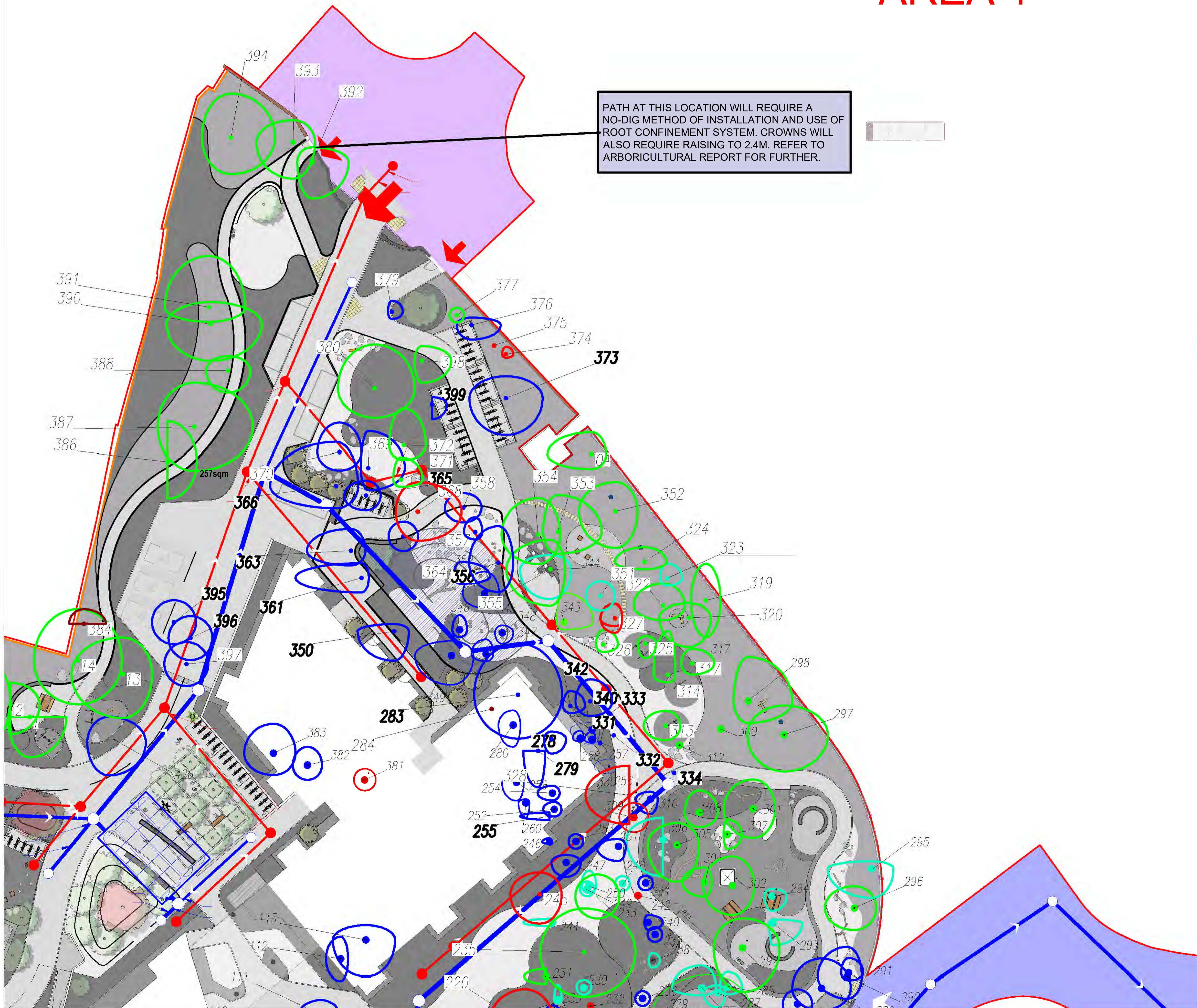

REV	DATE	COMMENT
	06/11/25	FOR REVIEW AND COMMENT
A	24/10/25	ADDITION OF EGLINGTON ROAD
B	18/11/25	REVISED IMPACT ON TREES
C	25/11/25	UPDATE TO LAYOUT

PROJECT: MILLTOWN PARK, SANDFORD, DUBLIN	JOB NO. TSAN001
DRAWING: IMPACT ASSESSMENT DRAWING - AREA 1	SCALE: 1:250 @A1
DRAWN BY: LAUREN MCCOLGAN	
STATUS: PLANNING	
DRAWING No: TSAN001-DR-8-CHK-ARB-002.1	



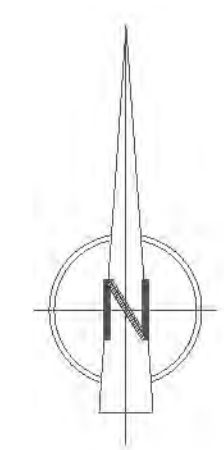

NOTES  
 1. For full details see Impact Assessment Report.  
 2. All trees to be removed are to be removed in accordance with the Arboricultural Report.  
 3. THE DRAWING IS THE PROPERTY OF CAK ARBORICULTURE & LANDSCAPE LTD.



ITM SURVEY GRID



# AREA 2

- LEGEND**
- TREE IMPACT ASSESSMENT KEY**
-  TREES FOR RETENTION
  -  TREES REMOVED DUE TO DEVELOPMENT
  -  CATEGORY C TREES TO BE REMOVED IN THE INTERESTS OF IMPROVING OPEN SPACE ACCESSIBILITY
  -  TREES RECOMMENDED FOR REMOVAL DUE TO ARBORICULTURAL PRINCIPLES

DRAWING TO BE INTERPRETED WITH REFERENCE TO THE ARBORICULTURAL ASSESSMENT & IMPACT REPORT



ENTIRE SITE N.T.S.



REV	DATE	COMMENT
	24/09/25	FOR REVIEW AND COMMENT
A	24/10/25	ADDITION OF EGLINGTON ROAD
B	18/11/25	REVISED IMPACT ON TREES
C	25/11/25	UPDATE TO LAYOUT

PROJECT:	MILLTOWN PARK, SANDFORD, DUBLIN	JOB NO.:	TSAN001
DRAWING:	IMPACT ASSESSMENT DRAWING - AREA 2	SCALE:	1:250 @A1
DRAWN BY:	LAUREN MCCOLGAN		
STATUS:	PLANNING		
DRAWING No:	TSAN001-DR-8-CHK-ARB-002.2		

**NOTES**  
 1. For All Sites, 10m Impact Assessment Only.  
 2. All to be confirmed by site visit and ground truthing.  
 3. This drawing is copyright of CAK ARBORICULTURE & LANDSCAPE LTD.

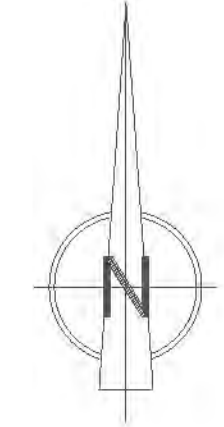

ITM SURVEY GRID



# AREA 3

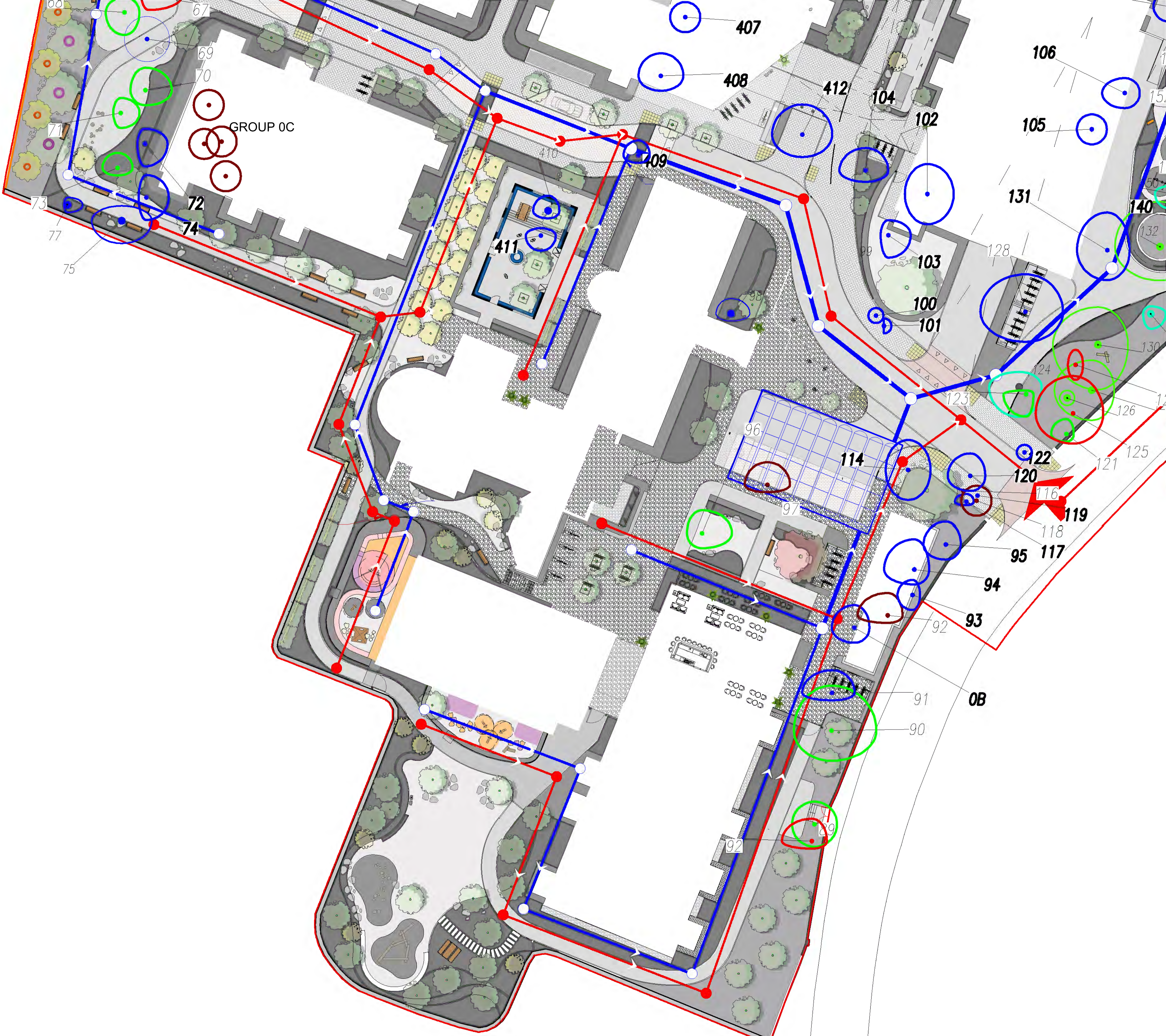

**LEGEND**

**TREE IMPACT ASSESSMENT KEY**

- TREES FOR RETENTION
- TREES REMOVED DUE TO DEVELOPMENT
- CATEGORY C TREES TO BE REMOVED IN THE INTERESTS OF IMPROVING OPEN SPACE ACCESSIBILITY
- TREES RECOMMENDED FOR REMOVAL DUE TO ARBORICULTURAL PRINCIPLES

DRAWING TO BE INTERPRETED WITH REFERENCE TO THE ARBORICULTURAL ASSESSMENT & IMPACT REPORT



ENTIRE SITE N.T.S.

REV	DATE	COMMENT
	24/09/25	FOR REVIEW AND COMMENT
A	24/10/25	ADDITION OF EGLINGTON ROAD
B	18/11/25	REVISED IMPACT ON TREES
C	25/11/25	UPDATE TO LAYOUT

PROJECT:	MILLTOWN PARK, SANDFORD, DUBLIN	JOB NO.:	TSAN001
DRAWING:	IMPACT ASSESSMENT DRAWING - AREA 3	SCALE:	1:250 @A1
DRAWN BY:	LAUREN MCCOLGAN		
STATUS:	PLANNING		
DRAWING No:	TSAN001-DR-8-CHK-ARB-002.3		

NOTES  
 1. For All Sites, 50% Open Space Provision.  
 2. All to be retained, unless otherwise specified.  
 3. The drawing is copyright of CAK ARBORICULTURE & LANDSCAPE LTD.

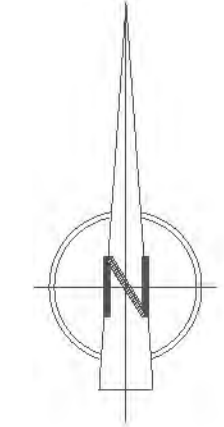



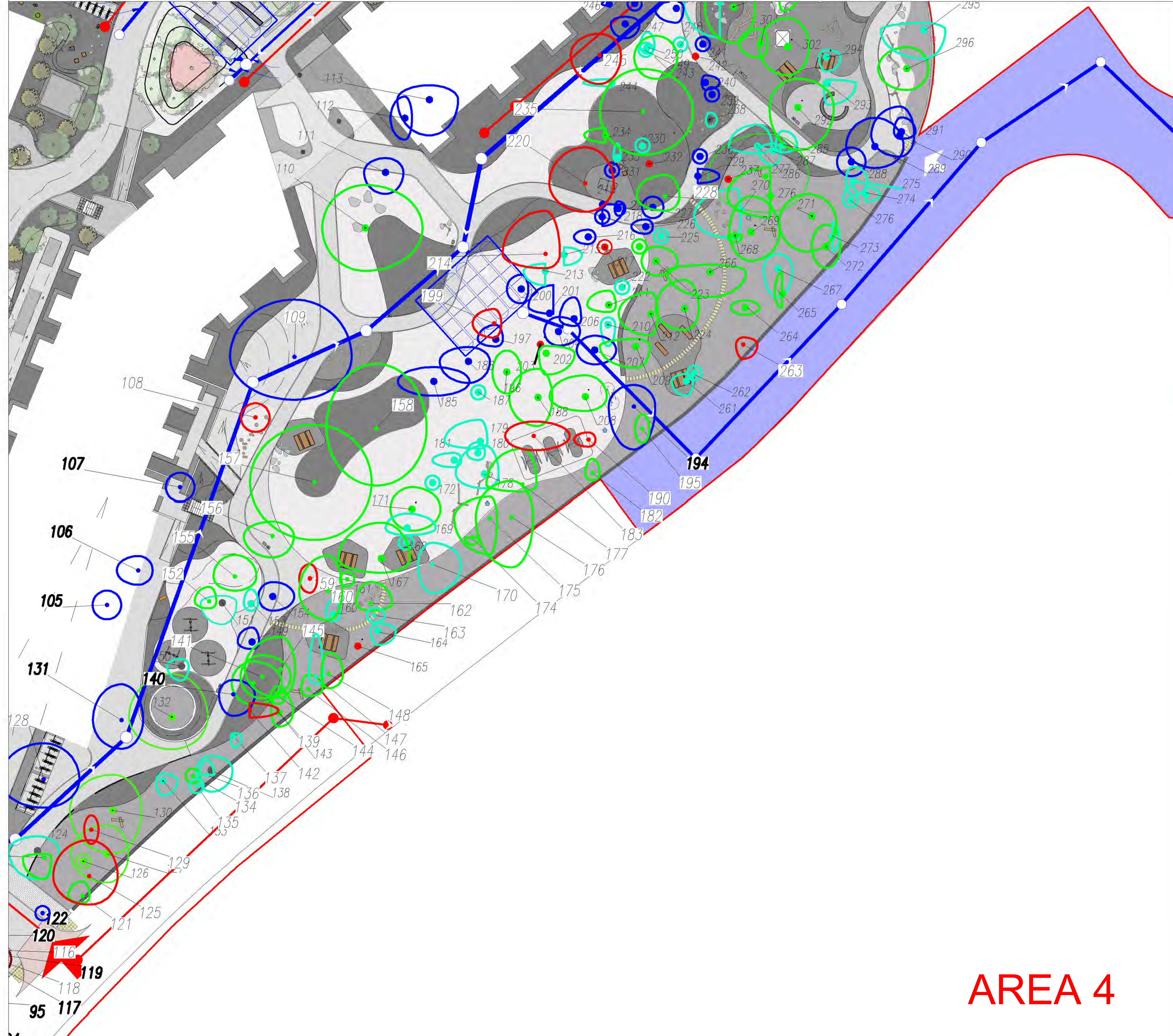

ITM SURVEY GRID





**LEGEND**

**TREE IMPACT ASSESSMENT KEY**

-  TREES FOR RETENTION
-  TREES REMOVED DUE TO DEVELOPMENT
-  CATEGORY C TREES TO BE REMOVED IN THE INTERESTS OF IMPROVING OPEN SPACE ACCESSIBILITY
-  TREES RECOMMENDED FOR REMOVAL DUE TO ARBORICULTURAL PRINCIPLES

DRAWING TO BE INTERPRETED WITH REFERENCE TO THE ARBORICULTURAL ASSESSMENT & IMPACT REPORT



ENTIRE SITE N.T.S.

# AREA 4

REV	DATE	COMMENT
	24/09/25	FOR REVIEW AND COMMENT
A	24/10/25	ADDITION OF EGLINGTON ROAD
B	18/11/25	REVISED IMPACT ON TREES
C	25/11/25	UPDATE TO LAYOUT

PROJECT:	MILLTOWN PARK, SANDFORD, DUBLIN	JOB NO.:	TSAN001
DRAWING:	IMPACT ASSESSMENT DRAWING - AREA 4	SCALE:	1:250 @A1
DRAWN BY:	LAUREN MCCOLGAN		
STATUS:	PLANNING		
DRAWING No:	TSAN001-DR-8-CHK-ARB-002.4		

NOTES  
 1. For full details, refer to the Arboricultural Impact Assessment Report.  
 2. This drawing is copyright of CAK ARBORICULTURE & LANDSCAPE LTD.

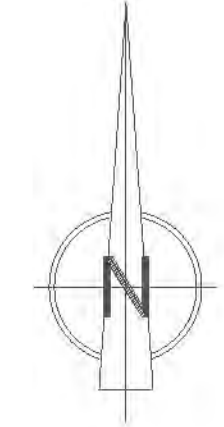





ITM SURVEY GRID



# AREA 5

## LEGEND

### TREE IMPACT ASSESSMENT KEY

-  TREES FOR RETENTION
-  TREES REMOVED DUE TO DEVELOPMENT
-  CATEGORY C TREES TO BE REMOVED IN THE INTERESTS OF IMPROVING OPEN SPACE ACCESSIBILITY
-  TREES RECOMMENDED FOR REMOVAL DUE TO ARBORICULTURAL PRINCIPLES

DRAWING TO BE INTERPRETED WITH REFERENCE TO THE ARBORICULTURAL ASSESSMENT & IMPACT REPORT



ENTIRE SITE N.T.S.

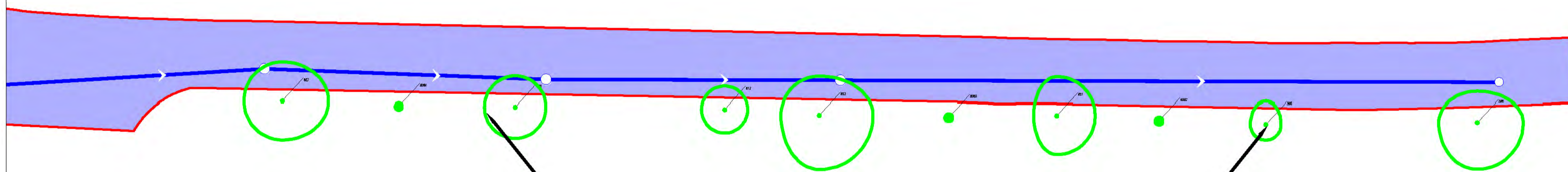

TREE ROOTS ARE LIKELY CONSTRAINED BY THE ROADWAY AND SOMEWHAT CONSTRAINED BY THE PATH, ALTHOUGH SOME MINOR ROOT DISTURBANCE OF PATH IMMEDIATELY ADJACENT TO TREES IS PRESENT.

REV	DATE	COMMENT
	24/09/25	FOR REVIEW AND COMMENT
A	24/10/25	ADDITION OF EGLINTON ROAD
B	18/11/25	REVISED IMPACT ON TREES
C	25/11/25	UPDATE TO LAYOUT

PROJECT: MILLTOWN PARK, SANDFORD, DUBLIN	JOB NO. TSAN001
DRAWING: IMPACT ASSESSMENT DRAWING - AREA 5 EGLINTON ROAD	SCALE: 1:350 @A1
DRAWN BY: LAUREN MCCOLGAN	
STATUS: PLANNING	
DRAWING No: TSAN001-DR-8-CHK-ARB-002.5	

NOTES  
 1. All trees to be retained are to be marked with a green circle.  
 2. All trees to be removed are to be marked with a blue circle.  
 3. All trees to be removed in the interests of improving open space accessibility are to be marked with a light blue circle.  
 4. All trees recommended for removal due to arboricultural principles are to be marked with a red circle.  
 5. The drawing is copyright of CAK ARBORICULTURE & LANDSCAPE LTD.

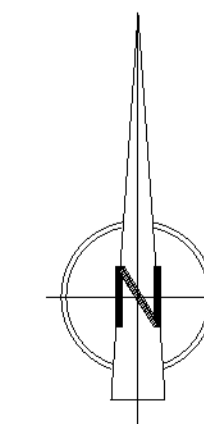

ITM SURVEY GRID

