

**CONTROL NOTES:**

AMENITY LIGHTING TO BE OPERATED DAILY FROM DUSK TILL DAWN. STREETLIGHTING TO SWITCH ON/OFF WITH A SLOW FADE UP/DOWN, PREPROGRAMMED INTO INTEGRAL DRIVER. TIMINGS TO BE SET BASED ON ADVICE FROM ECOLOGIST.

FEATURE LIGHTING TO SWITCH ON AT DUSK AND OFF AT A PREDETERMINED CURFEW OF 10:30PM. TO MINIMISE DISTURBANCE TO ROOSTING BATS, LIGHTING AROUND THE FORMAL GARDEN TO OPERATE OUTSIDE OF SUMMER MONTHS, IN ACCORDANCE WITH ECOLOGIST'S RECOMMENDATION.

IN AREAS DESIGNATED BY THE ECOLOGIST AS SUPPORTING BAT HABITAT BUFFER ZONES, LIGHT LEVELS TO BE SET TO APPROPRIATE LEVELS WITH THE USE OF REDUCED OUTPUT DRIVERS AND/OR DALI CONTROLLED DIMMING.

**GENERAL NOTES**

ALL FITTINGS MARKED 'e' ARE EMERGENCY AND REQUIRE MAINS POWER.

FINAL LIGHTING LOCATIONS TO BE COORDINATED WITH ARCHITECT AND LANDSCAPE ARCHITECT.

DEPTH AND LOCATIONS OF ROOT MOUNTED COLUMNS TO BE COORDINATED WITH UNDERGROUND SERVICES.

**FITTING TYPE NOTES:**

PT-A1: 6m STREET LIGHTING COLUMN WITH ROAD LIGHTING OPTIC.

PT-A2: 6m STREET LIGHTING COLUMN WITH FORWARD THROW OPTIC.

PT-A3: 6m STREET LIGHTING COLUMN WITH LINEAR OPTIC.

PT-B1: 6m COLUMN WITH 4no. PROJECTORS, EACH WITH WIDE BEAM OPTIC AND COWL.

PT-B2: 6m COLUMN WITH 3no. PROJECTORS, EACH WITH WIDE BEAM OPTIC AND COWL.

PT-C: 4m STREET LIGHTING COLUMN WITH PATHWAY LIGHTING OPTIC.

PT-D1: 800mm BOLLARD WITH DOWNWARDS LIGHTING DISTRIBUTION.

PT-D2: 800mm BOLLARD WITH DOWNWARDS LIGHTING DISTRIBUTION.

PT-E: 4m STREET LIGHTING COLUMN WITH HERITAGE STYLE LANTERN.

PT-G1: SOFFIT-MOUNTED DOWNLIGHT.

PT-G1e: SOFFIT-MOUNTED DOWNLIGHT WITH EMERGENCY POWER SUPPLY.

PT-G2: SOFFIT-MOUNTED DOWNLIGHT WITH WALL WASH OPTIC.

PT-H: INGROUND UPLIGHT.

PT-J: INGROUND UPLIGHT.

PT-K1: SMALL WALL-MOUNTED DOWNLIGHT.

PT-K2: WALL-MOUNTED DOWNLIGHT.

PT-K2e: WALL-MOUNTED DOWNLIGHT WITH EMERGENCY POWER SUPPLY.

PT-L: WALL MOUNTED LUMINAIRE WITH UP/DOWN LIGHT DISTRIBUTION, WITH LOUVRE GLARE CONTROL.

PT-M: WALL MOUNTED HERITAGE STYLE LANTERN.

PT-N: WALL MOUNTED LUMINAIRE WITH DOWNWARDS LIGHT DISTRIBUTION.

PT-P1: WALL MOUNTED MINI PROJECTOR WITH COWL.

PT-P1e: WALL MOUNTED MINI PROJECTOR WITH COWL AND EMERGENCY POWER SUPPLY.

PT-P2: SURFACE MOUNTED PROJECTOR WITH COWL AND LOUVRE.

PT-R1 - PT-R11: ILLUMINATED UNDERGROUND CAR PARK VENTILATION STRUCTURES.

PT-U1 - PT-U20: LINEAR LUMINAIRE WITH DOWNWARDS LIGHT DISTRIBUTION INTEGRATED INTO BENCH DETAIL.

PT-V1 - PT-V10: LINEAR LUMINAIRE WITH DOWNWARDS LIGHT DISTRIBUTION INTEGRATED INTO HANDRAIL DETAIL.

PT-W1: FEETCOON LIGHTING STRUNG BETWEEN 3m POLES.

PT-X: WALL RECESSED LUMINAIRE WITH DOWNWARDS LIGHT DISTRIBUTION.

PT-Ye: SOFFIT-MOUNTED DOWNLIGHT WITH EMERGENCY POWER SUPPLY.

PT-Z: SMALL FORM EXTRA COWLED INGROUND UPLIGHT, BURIED POTTED DRIVER.

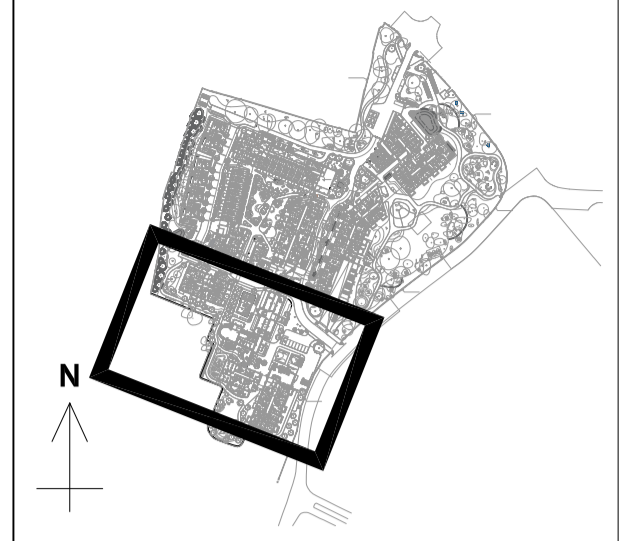

**SITE MAP**

**HATCH KEY:**

- AREAS WITHIN PROJECT BOUNDARY BUT OUTSIDE PRITCHARD THEMIS SCOPE AREAS.
- AREAS OUTSIDE PROJECT BOUNDARY.
- LIGHTING LAYOUT ILLUSTRATED ON OTHER DRAWING. REFER TO DRAWING NOTES FOR DRAWING NUMBER.



REV	DESCRIPTION	DATE	BY
F	GENERAL DESIGN UPDATE	04.12.25	PP
E	XREF UPDATE	31.05.23	LM
D	REVISIONS CLOUDED & XREF UPDATE	05.05.23	PP
C	REVISIONS CLOUDED & XREF UPDATE	24.08.21	LM
B	REVISIONS CLOUDED & XREF UPDATE	04.08.21	PP
A	REVISIONS CLOUDED	19.03.21	LB

THIS DRAWING IS THE PROPERTY OF PRITCHARD THEMIS LTD.  
 Drawing to be read in conjunction with PRITCHARD THEMIS LTD specification schedule.  
 All copyright is reserved and the drawing is issued on the condition that it is not copied, reproduced, retained or disclosed to any unauthorised person, either wholly or in part without the consent of PRITCHARD THEMIS LTD.  
 All electrical works associated with this drawing to be in accordance with the latest edition of IEE wiring regulations.

**CLIENT:**  
SANDFORD LIVING LIMITED

**PROJECT:**  
MILLTOWN PARK, SANDFORD ROAD, DUBLIN 6

**DRAWING TITLE:**  
EXTERNAL LIGHTING LAYOUT - SOUTH SITE PLAN

**JOB NO:**  
PTL762

**DRAWING NO:**  
PTL762 P01.1

**FIRST ISSUED:** 05.03.21      **REVISION:** F

**SCALE:** 1:250      **CREATED BY:** LB

**Pritchard Themis**  
 38 Bocking Street  
 London  
 E8 3EP  
 t: 00 44 (0) 207 650 0700  
 w: pritchardthemis.com